

Sinilink XY-AP100H 100W HIFI stereo Bluetooth digital power board module TPA3116

Extreme Edition
XY-AP100H

100W+100W
TPA3116D2 **HIFI Version 2.0**
Dimensional sound Bluetooth digital power amplifier board

USB Play Bluetooth 5.0 USB sound card HIFI Timbre

AUX Import phone APP

Adopt the rotary encoder used in high-end speakers

Stepless tuning feels smooth with one key start and stop

HI-FI sound quality

- ✓ Bass vigorous
- ✓ The high transparent
- ✓ Acclaim as the peak of perfection



Presented:
Xin Yi Lian
mobile phone
APP control support
Android
and IOS

Directory

Sinilink XY-AP100H 100W HIFI stereo Bluetooth digital power board module TPA3116	1
Directory	1
1.Comparison of AP100H and AP100L	3

2. function Introduction.....	5
3.Nude plate construction	6
4.Installation schematic diagram	7
5.Product size and weight	8
6.Product parameter information	9
7.Product actual auction display.....	10
8.How to download a mobile APP.....	12
9.How to connect to your cell phone APP.....	13
10.Notes for product use.....	15

1. Comparison of AP100H and AP100L

AP series 100W Bluetooth power amplifier board selection table		
Model	XY-AP100L Flagship version	XY-AP100H Extreme Edition
Picture		
Character	Designed by efficient Class-D stereo amplifier, with excellent audio performance, good distortion and anti-pop function, Sound mellow, voice permeability, superior sound	Designed by efficient Class-D stereo amplifier TPA3116D2, with super high fidelity (HIFI) and stronger driving ability
SinilinkAPP	YES	YES
Supply	DC8-26V/3A	DC8-26V/3A
Audio Input	Bluetooth+AUX+Udisk+USB soundmax	Bluetooth+AUX+U disk+USB soundmax
Volume control	Rotate 360 degrees by encoder	Rotate 360 degrees by encoder
Audio output	Speaker*2+3.5mm Audiojack	Speaker*2+3.5mm Audiojack
Output power	100W*2	100W*2
Output filter	NO filter	Professional audio LC filter
Protections	overcurrent, short circuit, overtemperature protection and electrostatic protection	over temperature, overvoltage, undervoltage, DC-detect and short circuit protection and electrostatic protection
Thermal solution	Heat sink and shell	Heat sink and shell
Speakers	4-8Ω, 30-300W	2-8Ω, 30-300W
Size(with shell)	58mm*58mm*18mm	60mm*60mm*20mm
Weight (including packaging)	68g	85g

Shock listed

Bluetooth power amplifier 100W+100W Ultimate Edition



2. function Introduction

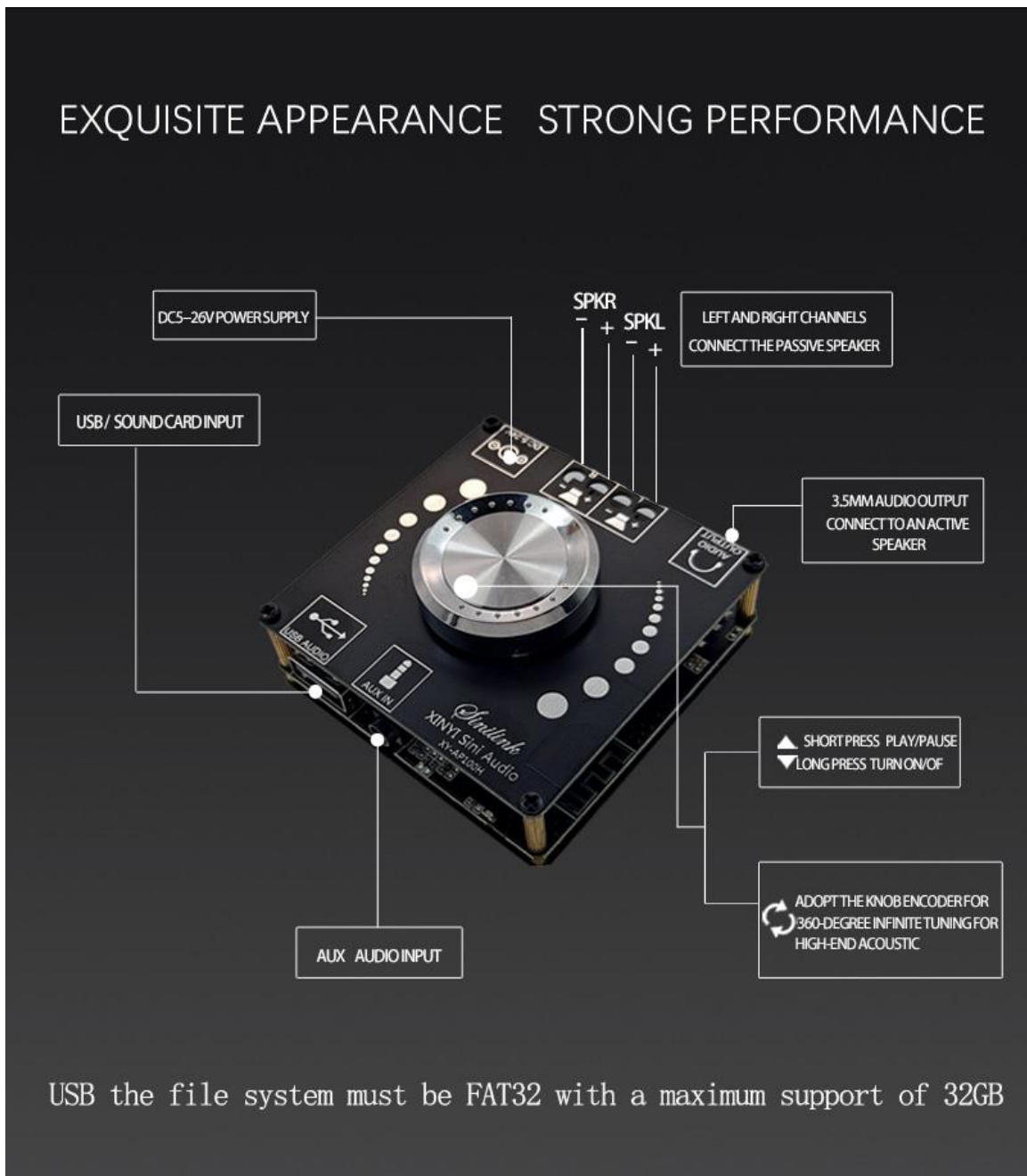

3.Nude plate construction

DISPLAY OF BARE PLATE CONSTRUCTION

High quality all-copper
DC plug has long life

Complimentary
DC adapte

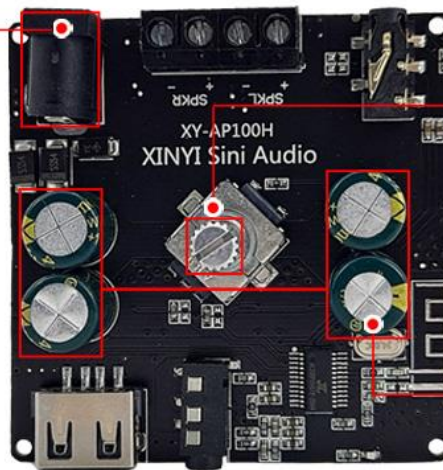

Adopts the rotary
coder used in
high-end speakers,
with no poletuning,
smooth hand feel
with one key start
and stop

High quality
energy storage
capacito



Complimentary large
area heat sink

Original imported
TPA3116D

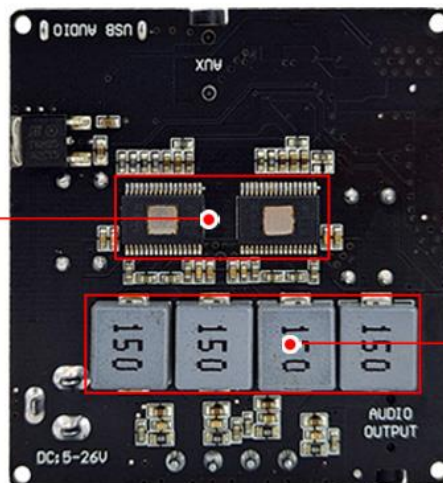

One - body
large current
inductor
to ensure full
power outpu

The bare board shows the real materia!

Note: There are 2 TPA3116D2 chips under the radiator, not 1.

4. Installation schematic diagram

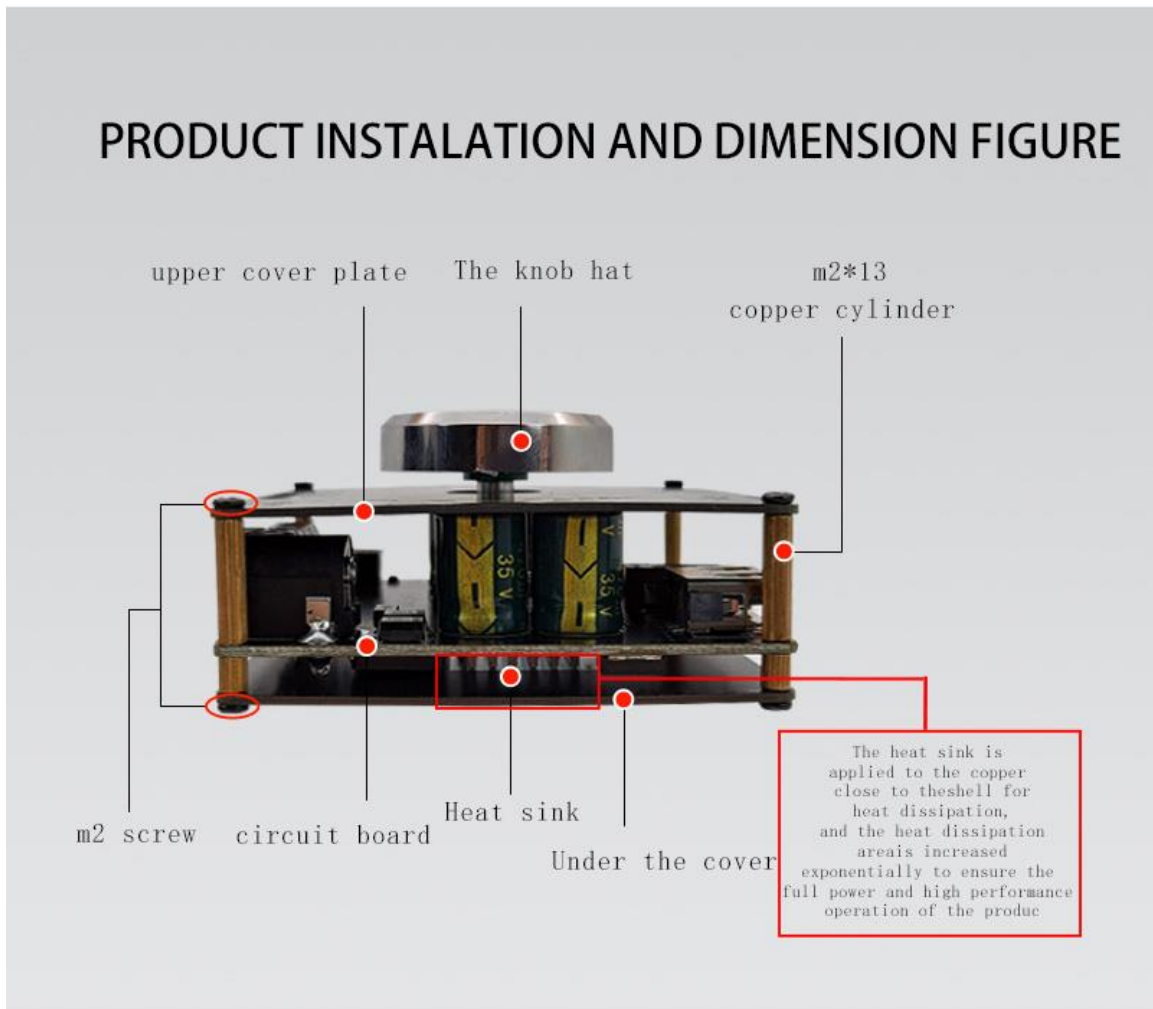

5.Product size and weight

PRODUCT SIZE CHART / PRODUCT SIZE CHART



Independent packaging of paper shell



Weight:85g

6.Product parameter information

TO CREATE THE MYTH OF BLUETOOTH HEADSET

Trademark: XINYI Sini Audio	Model: XY-AP100H
Bluetooth Core: 5.0	Fit the horn: 30W~300W 4Ω 8Ω 16Ω
Distance: 15m (unabgeschirmt)	Number of tracks: left and right dual tracks (stereo)
Power supply voltage :DC:5~26V(the higher the voltage, the greater the output power)	
Protection mechanism: power reverse connection protection, short circuit protection, self - recovery overheating protection	
12V→8Ω/30W+30W , 4Ω/40W+40W	
15V→8Ω/36W+36W , 4Ω/be greater than60W+60W	
19V→8Ω/64W+64W , 4Ω/be greater than90W+90W	
24V→4Ω/80W+80W , 2Ω/be greater than100W+100W	
Note: the output power of the power supply should be greater than the output power of the power amplifier, otherwise it will affect the sound quality	
Free cool features: Xin Yi Lian mobile phone APP control supports Android and IOS systems	

7. Product actual auction display

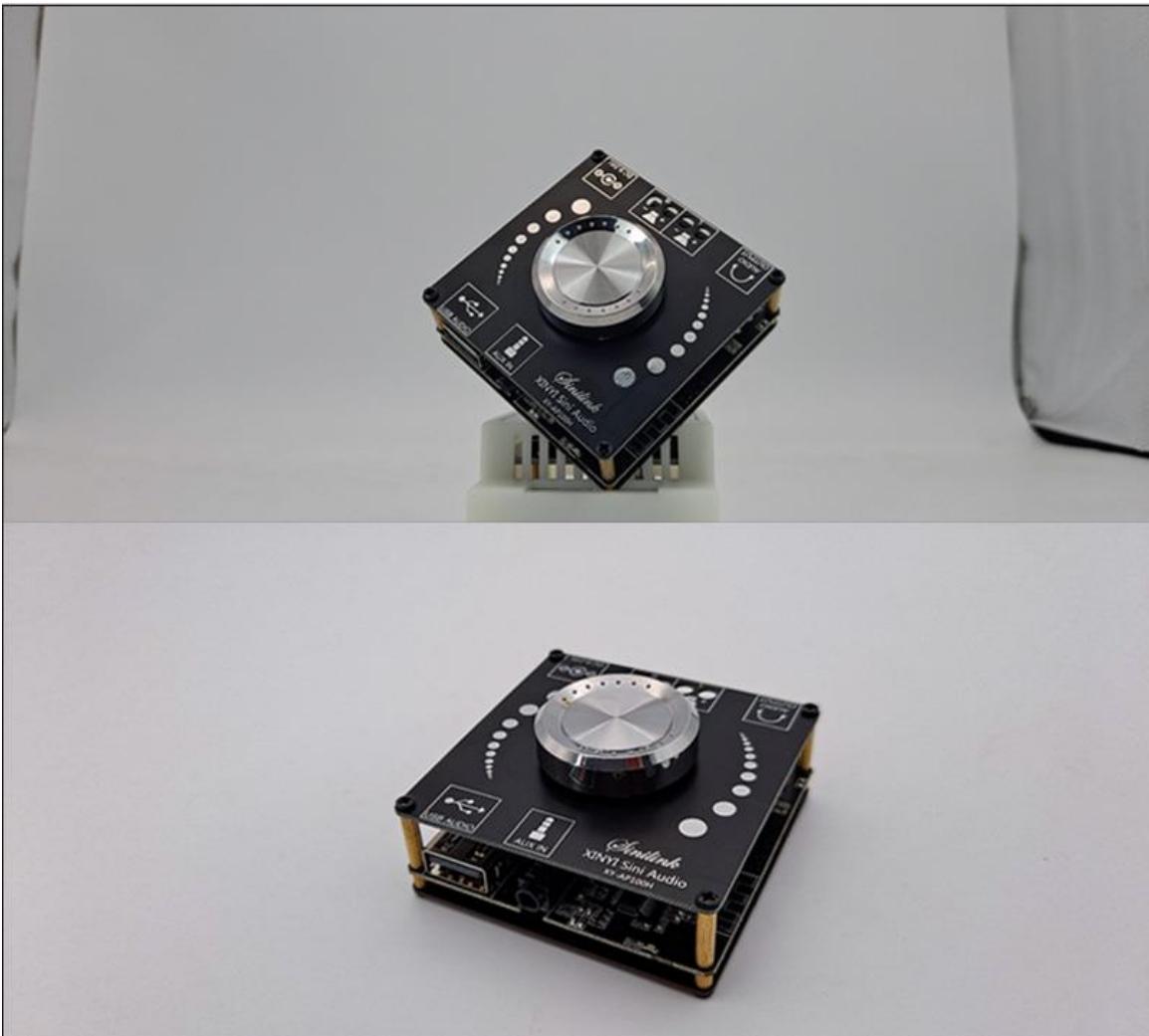

7. How to connect your mobile phone to Bluetooth



Do not connect to Sinilink-APP here, if it is connected, please unpair and search again

When the Bluetooth board is powered on, the blue LED flashes quickly and enters the Bluetooth connection mode; the mobile phone searches for XinYi, clicks "XinYi" to complete the connection and the sound is played, at this time the blue LED enters a long light state; open the mobile phone to play music, The blue LED flashes slowly and enters the playback state.

- 1) Make sure that Bluetooth enters Bluetooth connection mode- - -blue LED flash, AUX do not insert, can not enter Bluetooth connection state after insertion
- 2) Search for Bluetooth on the mobile phone, found "complete the connection after XINYI", click, accompanied with the prompt sound. After the successful connection, the LED enters the long beam state, open the mobile phone music software to play music, blue LED flash, enter the playing state;
- 3) When the phone searches for Bluetooth, come out. "Sinilink-APP", don't connect this Bluetooth here, this is connected inside the APP. If connected, please cancel the pairing and search again, otherwise it will cause you unable to connect inside the phone APP.

8.How to download a mobile APP

扫码下载APP



Scan Download APP



Scan the code to download APP, foreign customers please download in Google Market,hunt for 'sinilink' download.

9. How to connect to your cell phone APP

Give away cool features

Mobile APP control

Support Android Apple system



APP control

APP visual operation play mode

Volume Sound Effect Up and Down Song Control Play Pause Play Mode

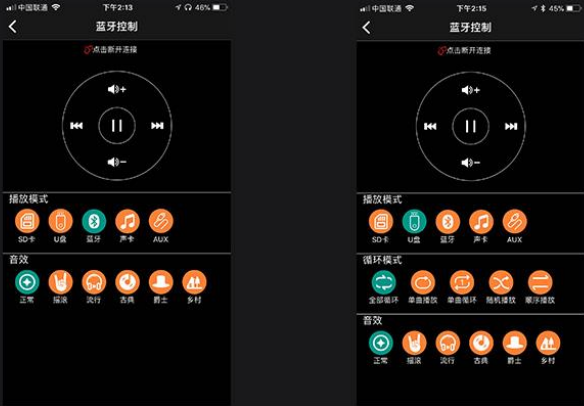

More functions will be upgraded in the future, so stay tuned

Steps to connect Bluetooth via mobile APP

Note: When using the APP, you must turn on all the APP permissions in the phone settings, otherwise some phones, compatibility issues will occur, causing Bluetooth to fail to connect.

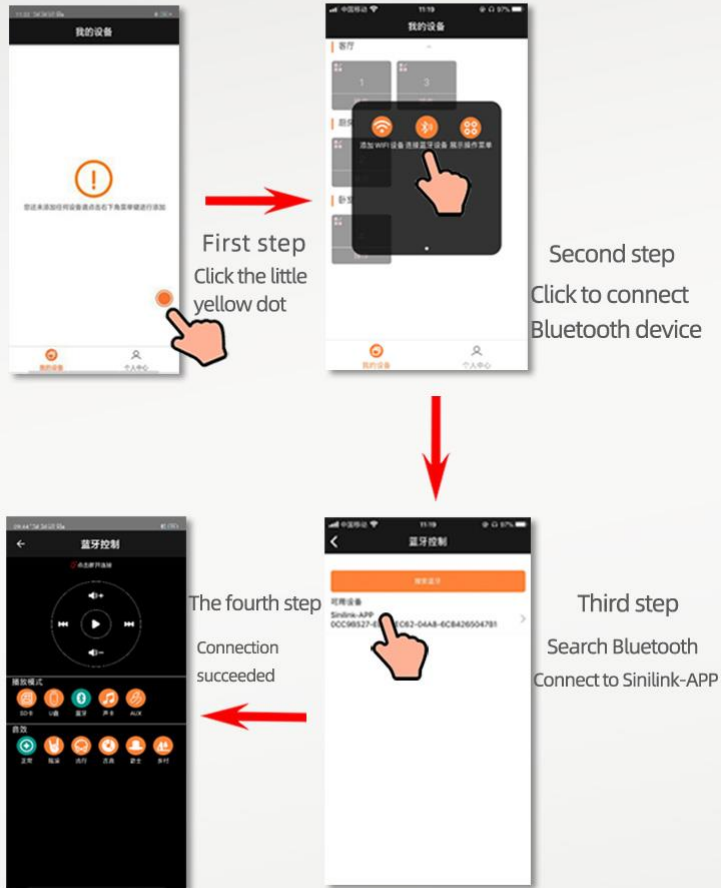

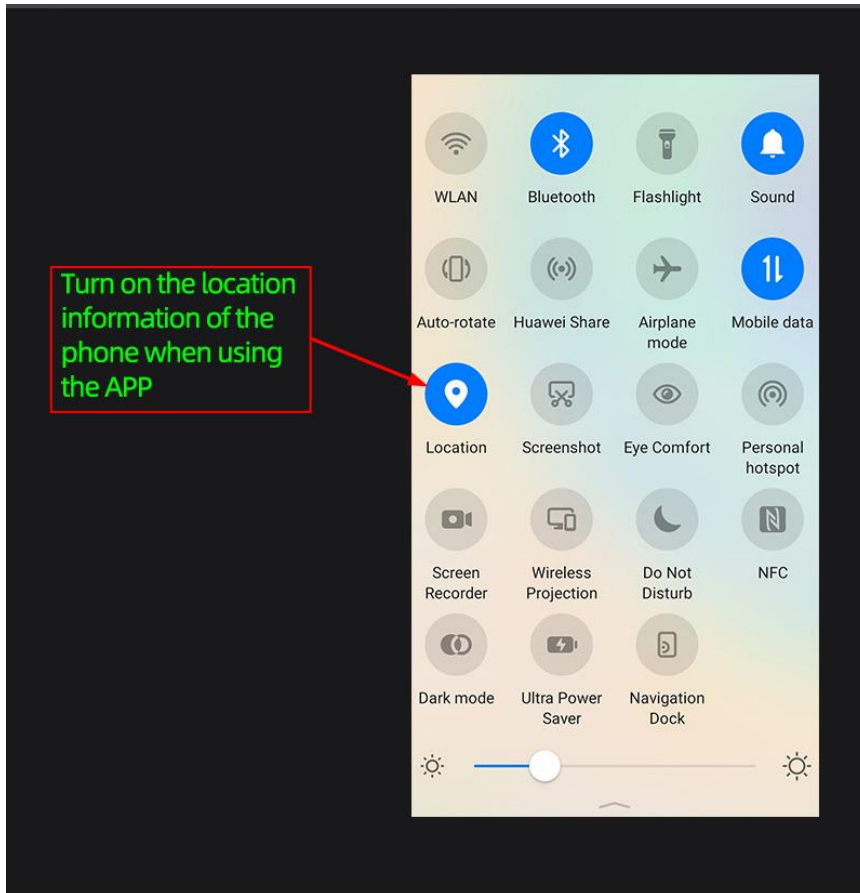

10. Notes for product use

Precautions for using APP

When using the APP, the Sinilink-APP cannot be searched. Check whether the Sinilink-APP is searched in the phone settings-Bluetooth interface. If it is searched (don't connect here), it means that the permission of the APP is not activated or the location information of the phone is not opened (very important), please go to the phone settings to open all the permissions of the APP and then reopen the APP search; if the Sinilink-APP is not searched in the phone settings-Bluetooth, please confirm whether the Bluetooth power amplifier board is powered on and enter the Bluetooth mode; if it is powered on and enters Bluetooth Please adjust the angle of the Bluetooth power amplifier board and search again.

Audio input mode switch

When this product is not mounted with any external audio device, the power-on default is Bluetooth mode; if the external playback device is mounted, such as inserting an AUX or U disk, the power-on default is AUX or U disk playback mode; the playback process follows the priority

of the rear plug-in device. In principle, for example, if you insert AUX during Bluetooth playback, you will immediately switch to AUX playback; the audio mode can also be switched by APP, which is very convenient.

When AUX is playing, try to choose AUX cable with shielding layer to reduce noise.

The MP3 format is recommended for U disk playback. The sampling rate of the WAV format must be within 44100Hz. If the sampling rate is too high, the playback may not be possible.

When using the USB sound card function, you can connect the computer with a USB data cable without installing any drivers. Most computer systems will switch the USB sound card by default. If it can't switch automatically, you can manually select the switch.

Power selection

This product has a power supply range of 5-26VDC and is compatible with standard 5.5-2.1/2.5 power adapter plugs. It is recommended to use a 12V/24V standard power adapter with a current output of 4A or more.

1) The size of the power supply is related to the power of the speaker used. For example, if you use a 4 ohm 100W speaker and a 24V power supply, the current should be at least 6A. If the current is too small, the sound may be stuck. Reduce the volume and reduce the output power to solve this problem .

2) The power supply voltage cannot be higher than 26V, higher than 26V, the circuit board will be burned.

3) If the horn does not play when the power is turned on, but keeps making a ticking sound, which is caused by insufficient power supply, just increase the power supply.

Speaker selection

The power amplifier of this product can continuously output 100W*2 power when driving 4Ω speakers, 50W~300W speakers can be driven, and 4ohm or 8ohm speakers are recommended. If the power is less than 100W speakers, appropriately reduce the power supply voltage (such as 21V power supply) or reduce the playback volume; the greater the power supply voltage of speakers greater than 100W, the better (within 26V).

If there is a "hiccup" phenomenon when playing music speakers, first consider the insufficient power supply and use a larger power supply; second, consider the power amplifier overheat protection, strengthen heat dissipation or reduce the playback volume.

Signal problem

This product uses a PCB antenna, and the visible distance of the connection can reach 15 meters without obstruction. If you can't find Bluetooth when you use it, or you can't connect to Bluetooth, consider the signal problem.

1) Keep away from the router when using it.

2) Avoid using it on the metal table, which will affect the PCB antenna signal.

3) If you refit the speaker, if it is a metal shell, you must lead the antenna out of the shell. The metal shell will shield the signal.